

## Off Plan Modern Apartments & Penthouse with Sea Views

Manilva > Manilva

Pre-launch • Apartments

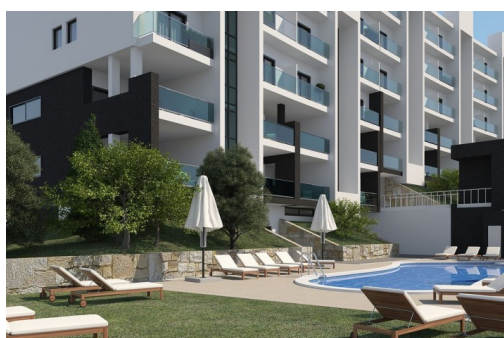

### INTRODUCTION

Residential complex of 2 and 3 bedroom apartments with 2 bathrooms, located in La Duquesa, Manilva. The complex has a swimming pool, gym, green areas, sea views. Excellent location, in the vicinity of the La Duquesa Golf Course and a few minutes from the beach. [Read more online...](#)

### KEY DETAILS

ARCHITECT:	NA	TYPE:	Apartments
LOCATION:	Manilva	UNITS:	48
AREA:	Manilva	BEDS:	2, 3
STATUS:	Pre-launch	PRICES:	€129,800–€219,800